

**ROTHERWICK ROAD,  
LONDON, NW11**



A desirable and well-presented detached family home with off street parking and dual side access leading to a stunning manicured rear garden, further benefitting from direct access to a sizeable paddock behind.

The generous and flexible accommodation is arranged over three floors with a further floor of usable loft space. Comprising of: entrance hall, reception room, family/dining room, kitchen/breakfast room, drawing room, utility room, functional second kitchen/utility, principal bedroom suite with dressing room, 6 further bedrooms, office space or 8th bedroom , 3 further ensuite bathrooms, family bathroom and guest cloakroom.

Conveniently located moments from the Heath Extension, walking distance to Golders Hill Park and the extensive transport facilities at Golders Green Station (Northern Line), many local shops, boutiques, cafes and restaurants and the excellent schooling available in this area and adjoining Hampstead.

**FREEHOLD**

**PRICE ON APPLICATION**















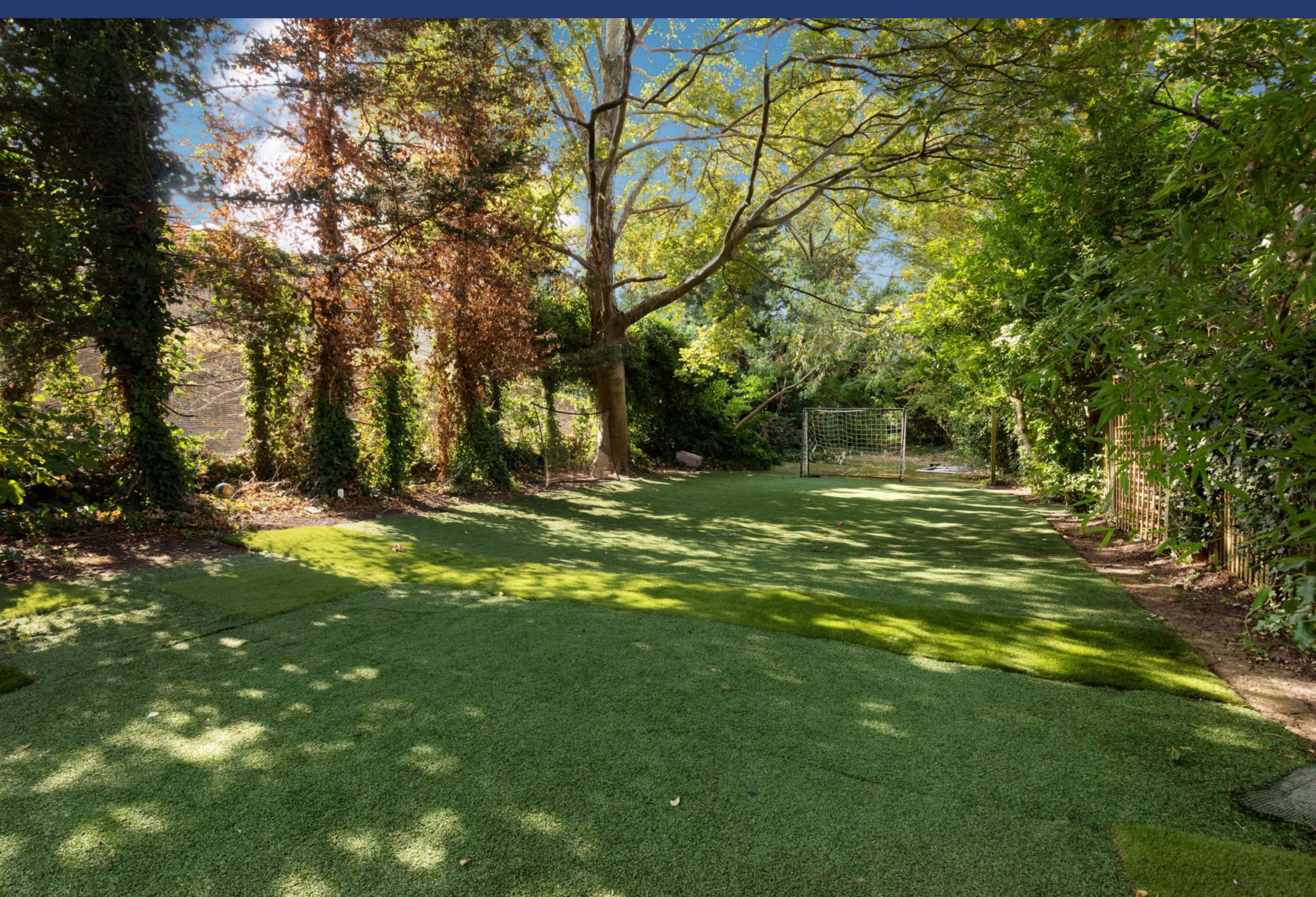

# Rotherwick Road NW11 ←

Gross internal area (approx.)  
 394 Sq m (4243 Sq ft) Including under 1.5m  
 356 Sq m (3831 Sq ft) Excluding under 1.5m  
 Acre 0.098 (approx.)

For identification only, Not to Scale

Garden  
 Approximately  
 51' 9"x34' 6"  
 (15.77x10.52)



Basement



Ground Floor



First Floor

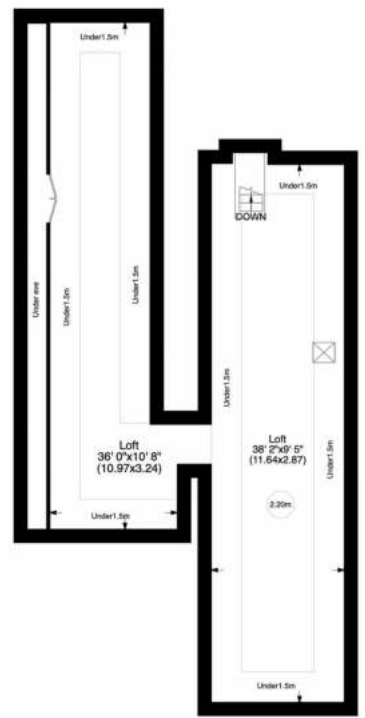

Second Floor

